

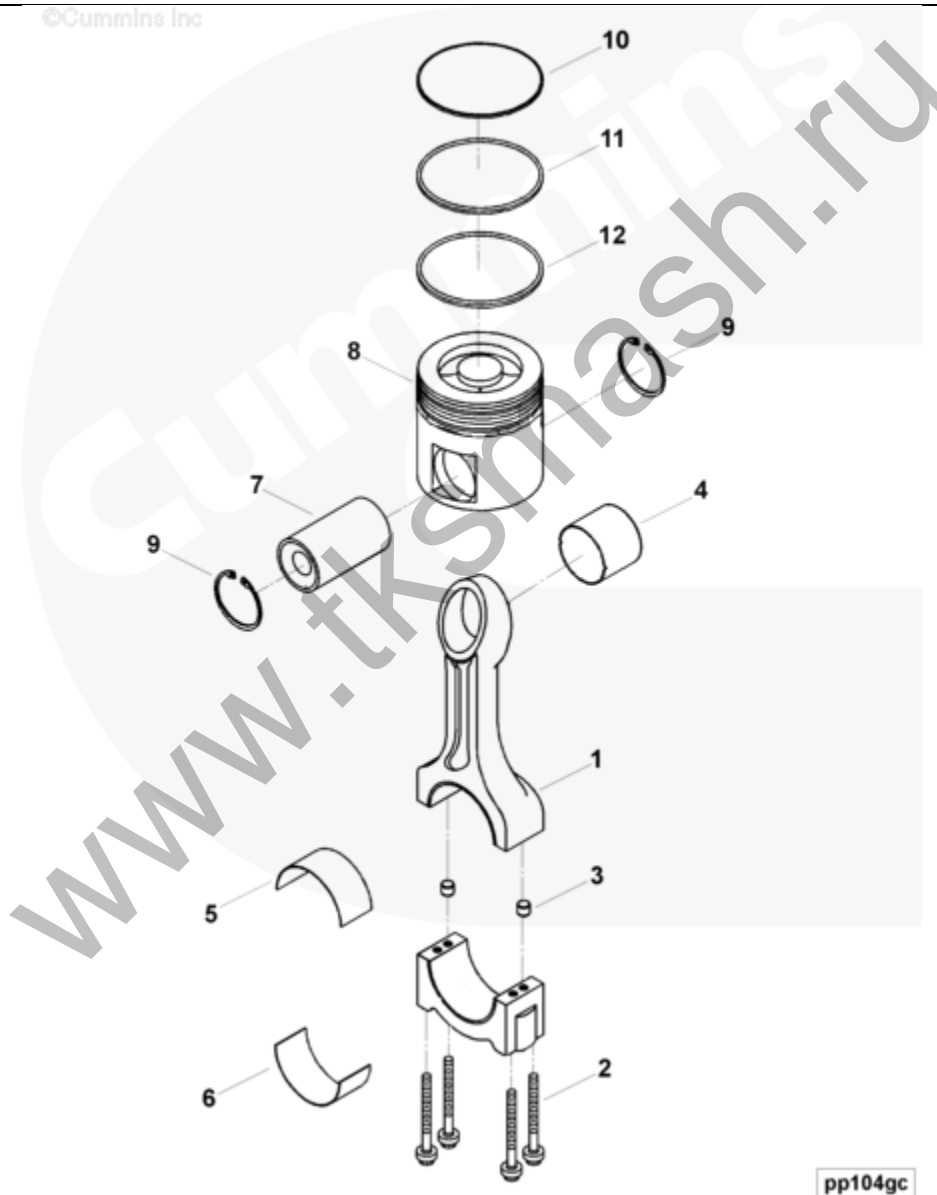

## Каталог деталей - Сведения о варианте

Электронный каталог деталей - описание данного варианта				
Доп. устройство	Группа	Рисунок	Карта	Дата
PP43087	01.04	pp104gc	SS	07-NOV-07
Двигатели	ISX CM570, ISX CM870, ISX CM871, ISX CM871 E, ISX15 CM2250, ISX15 CM2250 SN, ISX15 CM2350 X101, ISZ13 CM2150 SN, QSX11.9 CM2250 ECF, QSX15 CM2250, QSX15 CM2250 ECF, QSX15 CM2250 X115, QSX15 CM2350 X105, QSX15 CM2350 X106, QSX15 CM570, QSZ13 CM2150 Z101, QSZ13 CM2150 Z102, X15 CM2350 X114B, X15 CM2350 X116B			



pp104gc

[МАЛЫЙ](#) | [СРЕДНИЙ](#) | [БОЛЬШОЙ](#)

Cart	Ref No	Part Number	Part Description	Required	Remarks
<a href="#">View My Cart</a>					
		<a href="#">PP43087</a>	Шатун и поршень		<a href="#">Connecting Rod And Piston...(More)</a>
					Engine Piston

					Certified Model Name: QSX-15
					Timing Gear Code: 46
					CPL: 3087
					Certified By: EPA ,CARB, EU
					AFC: N/A
					ASA: N/A
					EFC: N/A ETC: Yes
					Manifold Type: Dry
					Engine Aspiration:
					Turbocharged Aftercooled
					Engine Control System: API
					Application: Nonroad
					Power Turbine: N/A
					Design Phase: API
					Power Rating: Intermittent
					ECM Version: N/A
					Centinel Provision: No
					Cert Level:
					Tier 3 Tier 3 Stiia
<input type="checkbox"/>		<a href="#">4059429</a>	Engine Connecting Rod	6	Ref TSB120067
	1	<a href="#">4059449</a>	Engine Connecting Rod	6	
<input type="checkbox"/>	2	<a href="#">3678574</a>	Connecting Rod Cap Screw	4	
<input type="checkbox"/>	3	<a href="#">3678739</a>	Ring Dowel	2	
	4	<a href="#">4059448</a>	Втулка	1	
	5	<a href="#">4925971</a>	Connecting Rod Bearing	6	Ref TSB120067
	6	<a href="#">4925975</a>	Connecting Rod Bearing	6	Serviced as 4089405
<input type="checkbox"/>	7	<a href="#">4923748</a>	Piston Pin	6	
<input type="checkbox"/>	8	<a href="#">3104186</a>	Поршень двигателя	6	Serviced as 4955227.
<input type="checkbox"/>	9	<a href="#">3064305</a>	Retaining Ring	12	
<input type="checkbox"/>	10	<a href="#">3684010</a>	Compression Piston Ring	6	Top.

<input type="checkbox"/>	11	<a href="#">3681078</a>	Compression Piston Ring	6	
	12	<a href="#">3682398</a>	Oil Piston Ring	6	
<input type="checkbox"/>		<a href="#">4089405</a>	Connecting Rod Bearing Kit	1	Std. Ref. TSB120067
		<a href="#">4925971</a>	Connecting Rod Bearing	1	Ref TSB120067
		<a href="#">4925975</a>	Connecting Rod Bearing	1	Serviced as 4089405
<input type="checkbox"/>		<a href="#">4090016</a>	Rod Bearing (.010) Kit	1	.25mm
		<a href="#">4925972</a>	Connecting Rod Bearing	6	(Drilled) Serviced as 4090016
		<a href="#">4925976</a>	Connecting Rod Bearing	6	(Lower) Serviced as 4090016
<input type="checkbox"/>		<a href="#">4090017</a>	Rod Bearing (.020) Kit	1	.50mm
		<a href="#">4925973</a>	Connecting Rod Bearing	6	(Drilled) Serviced as 4090017
		<a href="#">4925977</a>	Connecting Rod Bearing	6	(Lower) Serviced as 4090017
<input type="checkbox"/>		<a href="#">4089406</a>	Piston Ring Set	6	
		<a href="#">3682398</a>	Oil Piston Ring	1	
<input type="checkbox"/>		<a href="#">3683008</a>	Compression Piston Ring	1	
<input type="checkbox"/>		<a href="#">3681078</a>	Compression Piston Ring	1	
<input type="checkbox"/>		<a href="#">4955227</a>	Engine Piston Kit	6	
<input type="checkbox"/>		<a href="#">3064305</a>	Retaining Ring	2	
<input type="checkbox"/>		<a href="#">3104186</a>	Поршень двигателя	1	
<input type="checkbox"/>		<a href="#">4089406</a>	Piston Ring Set	1	

© 2017 Cummins Inc., Box 3005, Columbus, IN 47202-3005 U.S.A.  
 Условия использования и отказа от ответственности | Рекомендуемые требования к системе  
 Need Assistance? Please click on the Contact Us button in the top right corner of any page.